

In Order of vacating portion see Reg 4867-467 in Lib 1522 page 529  
**SHEPARD AND MORSE'S**  
 ADDITION TO PLYMOUTH VILLAGE  
 ON THE NW 1/4 OF SEC. 35 IN T. 18 S. E. WAYNE COUNTY MICHIGAN

*Description of the land vacated*  
 The land embraced in the original plat of the addition to Plymouth Village, as described in the original plat of the addition to Plymouth Village, is situated in the NW 1/4 of Sec. 35, T. 18 S., E. 1/2 W., Wayne County, Michigan. The land is bounded on the north by the line of the original plat, on the east by the line of the original plat, on the south by the line of the original plat, and on the west by the line of the original plat. The land is divided into lots numbered 1 through 42. The land is vacated for the purpose of being used as a public highway.

Examined and Approved  
 John A. Witherspoon General  
 Register of Deeds

P.N. FOR PART VACATION SEE L 1337 P 438  
 DEEDS; CIR. CT. FILE # 78507  
 PART VACATED SEE L 1474 P 246 DEEDS  
 CIR. CT. FILE # 80105

REG NO 69176  
 Co Term No 19676

72.0

REGISTER OF DEEDS OFFICE }  
 WAYNE COUNTY, }  
 This instrument was received for record this  
 30th day of May 1902 at 10 o'clock  
 of A.M. and recorded in Liber 22 of  
 of Deeds, on page 72, as proper certificate was  
 furnished in compliance with Sect. 185, of Senate  
 Bill No. 199 File 212, Act of 1898.  
 A. H. Angley  
 Register of Deeds

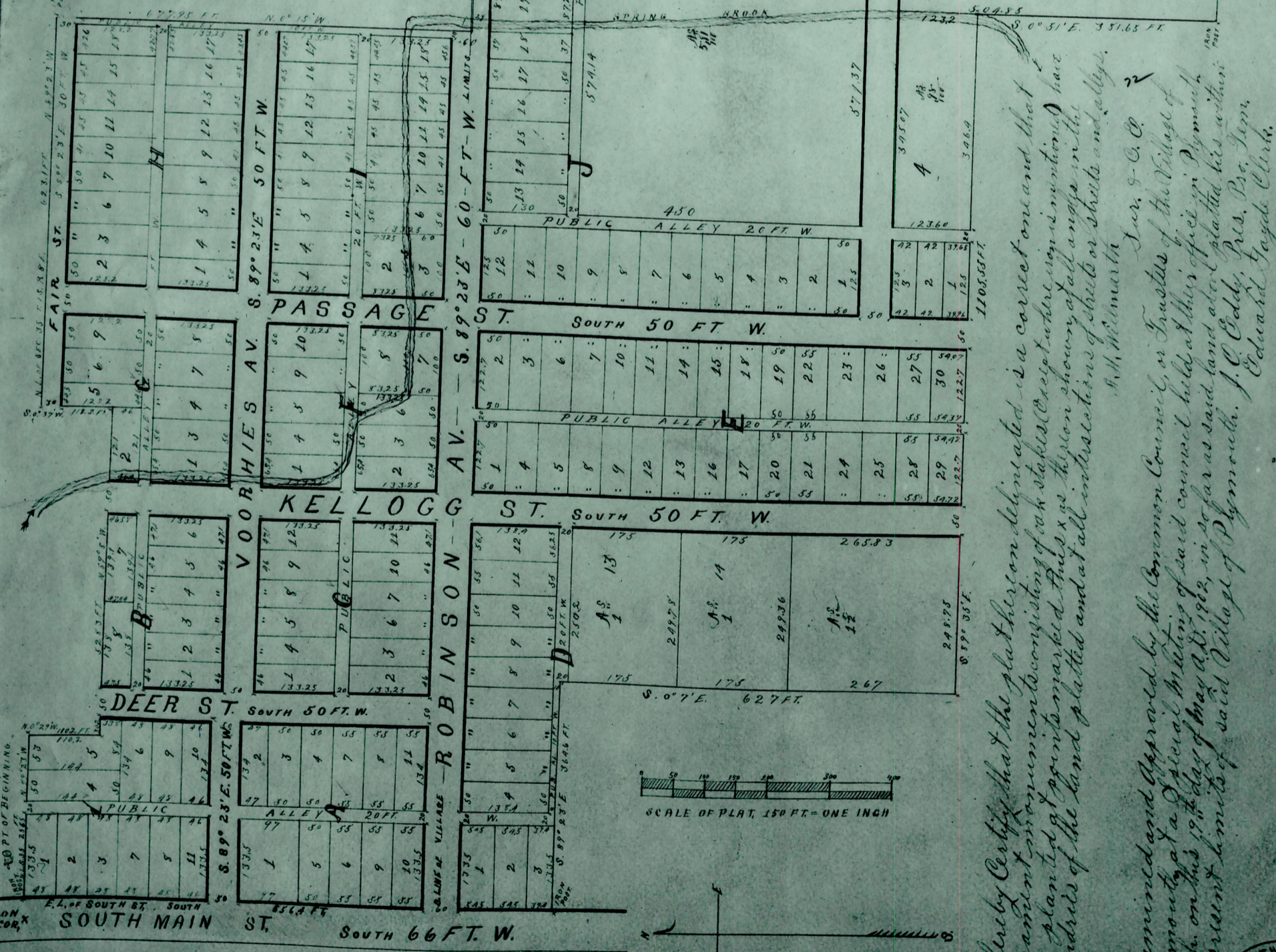

Know all men by these presents that as William A. Shepard and Mrs. S. Shepard his wife, do hereby certify that the plat of the addition to Plymouth Village, as described in the original plat of the addition to Plymouth Village, is situated in the NW 1/4 of Sec. 35, T. 18 S., E. 1/2 W., Wayne County, Michigan. The land is bounded on the north by the line of the original plat, on the east by the line of the original plat, on the south by the line of the original plat, and on the west by the line of the original plat. The land is divided into lots numbered 1 through 42. The land is vacated for the purpose of being used as a public highway.

Examined and Approved by the Common Council, as Trustees of the Village of Plymouth, at a Special Meeting of said Council held at their office in Plymouth, Mich. on this 19th day of May A.D. 1902, in so far as said land and plat thereof are within the present limits of said Village of Plymouth.  
 J. C. Eddy, Pres. Pse. Term.  
 Edward Foyde, Clerk.

State of Michigan }  
 County of Wayne }  
 A. R. Timpany  
 Surveyor, hereby certifies that we have  
 each carefully compared this copy with the original plat of Shepard and  
 Morse's Addition to Plymouth Village, and that it is an exact copy  
 thereof and of the whole of such original map or plat.

A. H. Angley  
 Register of Deeds  
 Wayne County, Michigan

L 22 P 521